



# Product Support Bulletin 2020-002

245 W. Forest Hill Avenue  
Oak Creek, WI 53154

Contact: Technical Support Phone: 800-445-9258 or Email: [TechSupport@Nordco.com](mailto:TechSupport@Nordco.com)

## Maintenance of Way ~ Work Equipment Bulletin

**DATE:** June 26, 2020

**SUBJECT:** Replacement of Axle Bearing Mounting Bolts.

**RATING:**  **DIRECTIVE**  
(Action is required)

**ALERT**  
(Potential Problem)

**INFORMATION**  
(Action is optional)

**PRODUCT IMPROVEMENT**  
(Enhance Product)

**MACHINE MODEL(S):** Ride on Tie Plugger (RTP)

**SERIAL NUMBER(S):** ALL (S/N starting with 530001 and higher)

**SUMMARY:** The original bolts used to mount the axle bearings to the frame were 4" long. At this length, there was a potential of the bolts shearing off during certain activities. One example of this would be when loading machines on to scorpion cars.

**OPERATIONAL IMPACT:** Replacing the original 3/4"-10 x 4" Grade 5 axle bearing mounting bolts with 3/4"-10 X 3.5" Grade 8 bolts will help prevent the bolts from shearing off.

**ACTION:** Remove the existing 3/4"-10 x 4" Grade 5 axle bearing mounting bolts one at a time and replace them with 3/4"-10 X 3.5" Grade 8 bolts P/N 2776105 and torque them to approximately 380ft. lbs. There are two bolts per bearing and a total of eight bolts per machine, allow approximately one hour per machine for change out. See Figure 1.

**WARRANTY:** None

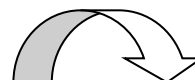

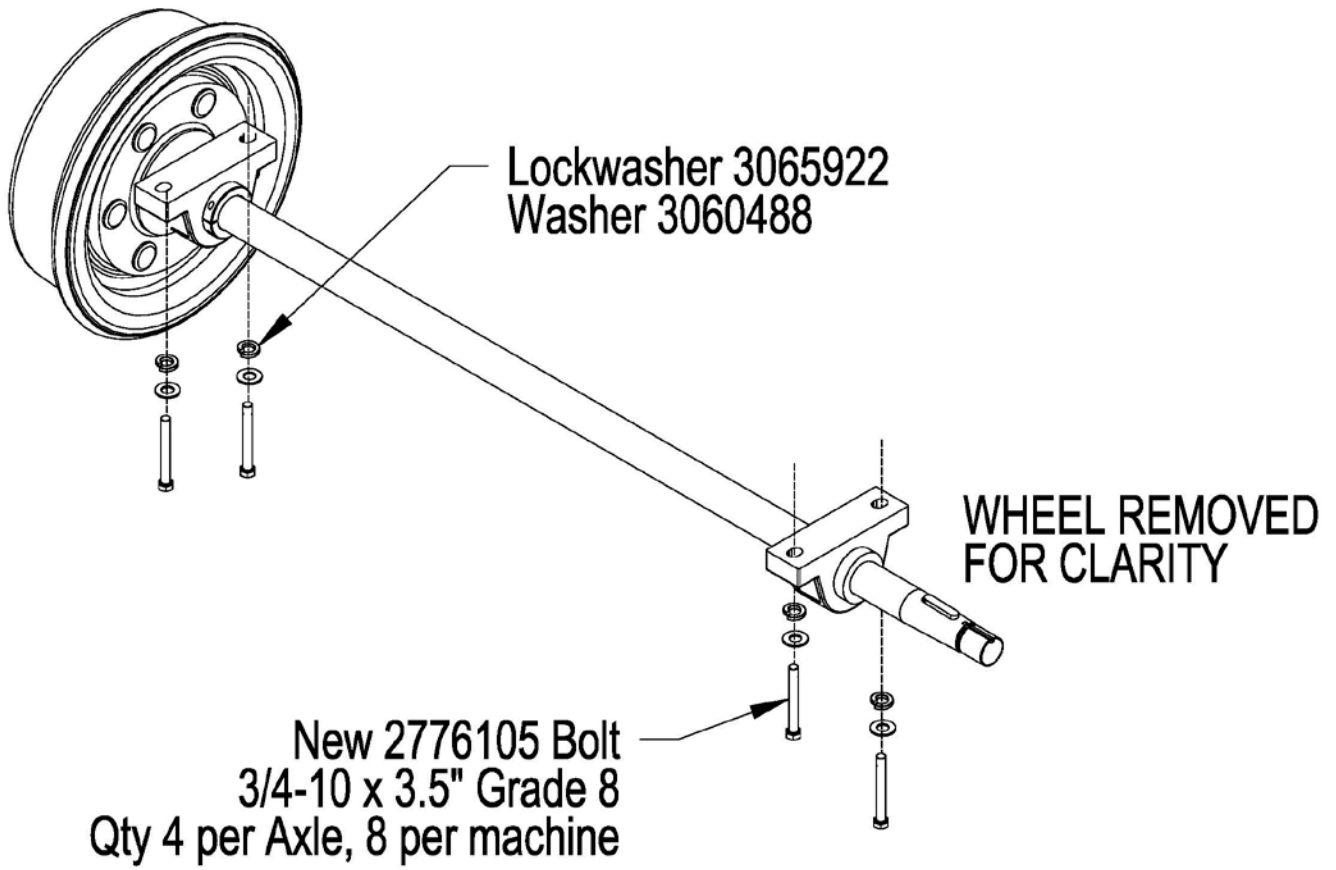

FIGURE 1